

The logo for Lake Forest Park features a stylized brown 'X' shape. The upper-left portion of the 'X' is set against a light green background, while the lower-right portion is set against a light blue background.

Lake Forest Park

**SAFE HIGHWAYS**

Accessible Efficient Complete

---

SR 522 Open House

November 14, 2017

# Agenda

- Welcome
- What is this project?
- What do we know about the SR 522 corridor today?
- What we want to hear from you!
- Station layout



NE 145th St





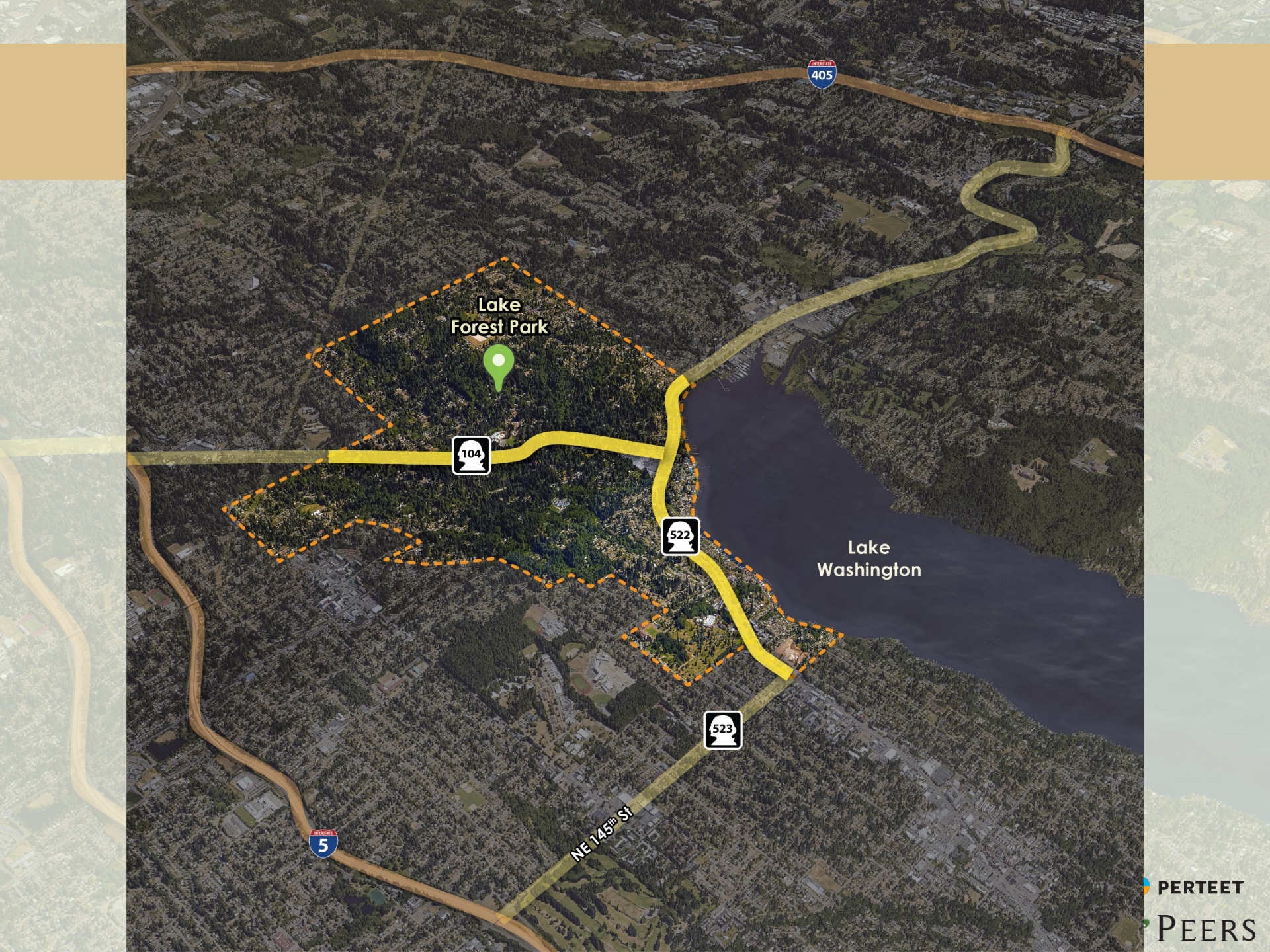

Lake Forest Park

Lake Washington

NE 145th St



# What is the Project?

## Comprehensive Corridor Study

### Complete connections for all modes

- ✓ Inviting connections for walking & biking
- ✓ Completion of the BAT lanes and consideration of P&R
- ✓ Access control & intersection treatments to maintain mobility

### Supported by the community

- ✓ Distinct corridor visions
- ✓ Integration with Safe Streets project
- ✓ Public support for recommended improvements recognizing years of construction

### Realistic & implementable

- ✓ Sound operations analysis and modeling
- ✓ Right-of-way considerations
- ✓ Project phases considered
- ✓ Recommendations have to work



# SR 522 Products

- More detailed Corridor Plan including:
  - Preferred cross-sections
  - SR 522/145<sup>th</sup> Street intersection concept
  - Non-Motorized Access improvements

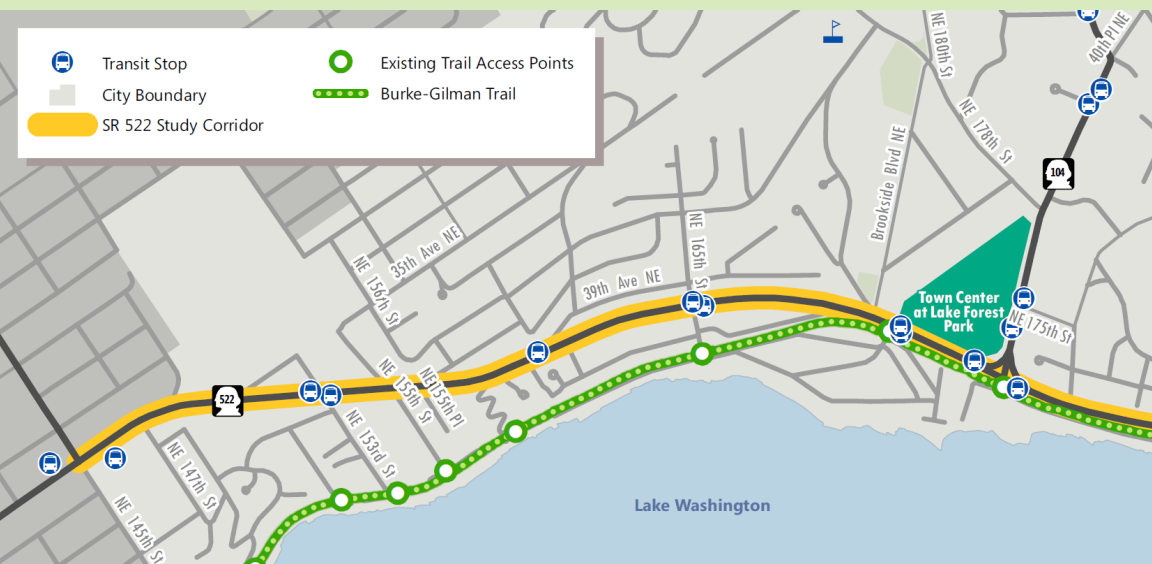

## SR 522 Concepts

Concept 1

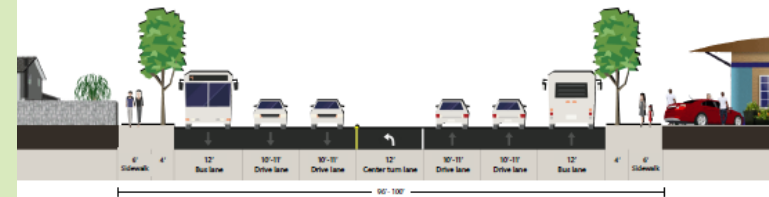

Concept 2

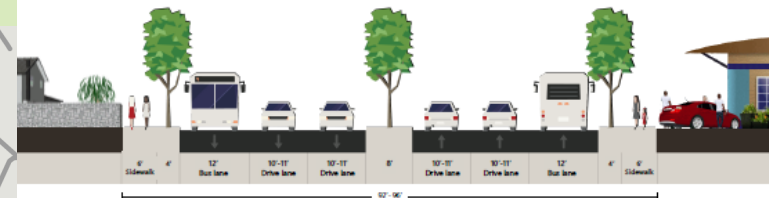

Concept 3

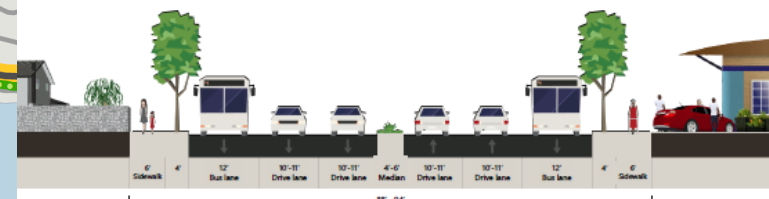

# Sound Transit 3 Project

- Detailed engineering for the corridor
- Right-of-way determinations & mitigation identification
- Final station locations
- Design of park & ride facilities

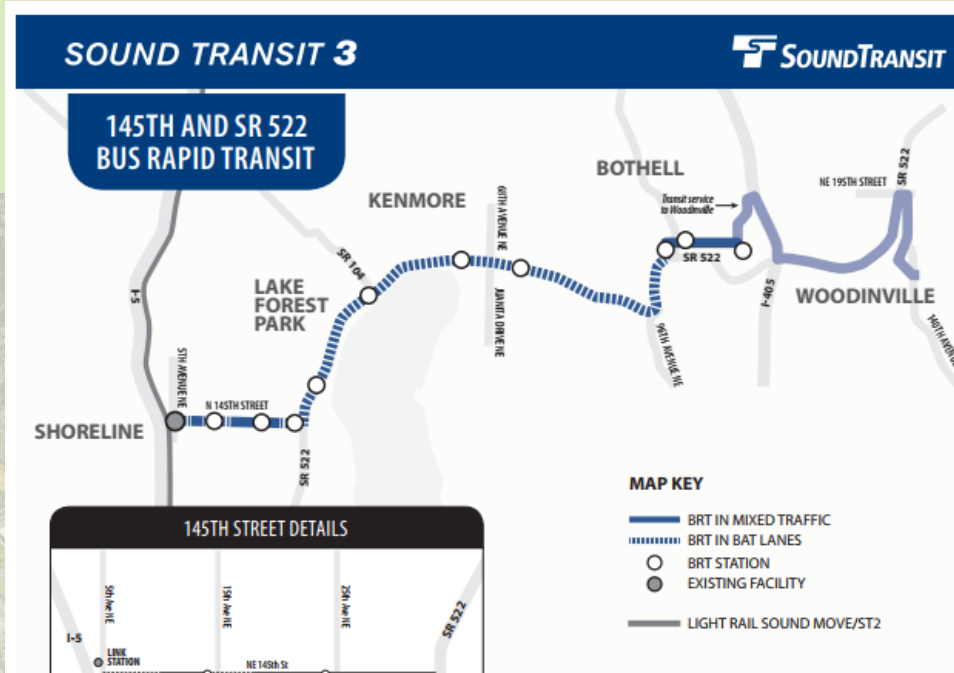



# Stakeholder Interviews

- **Completed interviews with key findings documented from:**
  - Business owners
  - Residents
  - Interest groups (Cascade Bicycle Club, Friends of Third Place Commons)
  - Merlone Geier (Town Center Owner)
  - Neighboring cities (Mountlake Terrace, Shoreline, Kenmore, Seattle)



# SR 522 Guiding Principles



- Address **safety** for all modes
- **Complete business access transit (BAT) lanes and full sidewalk connections** to support both BRT and local access
- **Minimize impacts** on neighboring properties (e.g. right-of-way, access, noise, visibility)
- **Improve non-motorized access to transit** and crossing opportunities to enhance local access
- **Create a corridor identity/character** and enhance the **natural environment**
- Be a leader in identifying **innovative solutions**, particularly at the Bothell Way/145th Street intersection



# Planning Context Report

**Documents existing conditions, opportunities, and challenges for each segment**

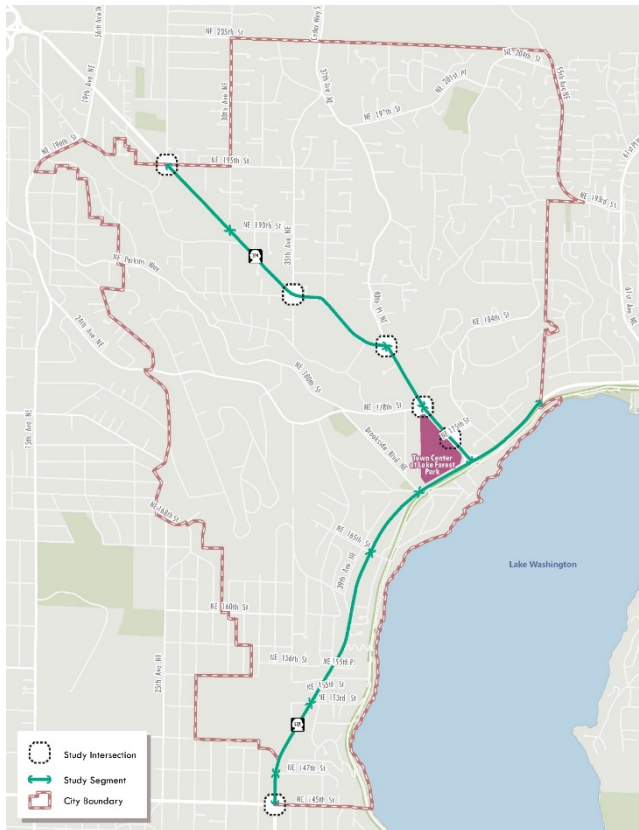

**Context & Land Use**



**Ped/Bike Amenities**



**Transit**



**Vehicle Operations**



**Safety**



**Utilities/Stormwater/ROW**

# SR 522 Today





# SR 522 Today





# SR 522 Today





# SR 522 Today





# SR 522 Today





# SR 522 Today



# ST3 Project

## SOUND TRANSIT 3



### 145TH AND SR 522 BUS RAPID TRANSIT

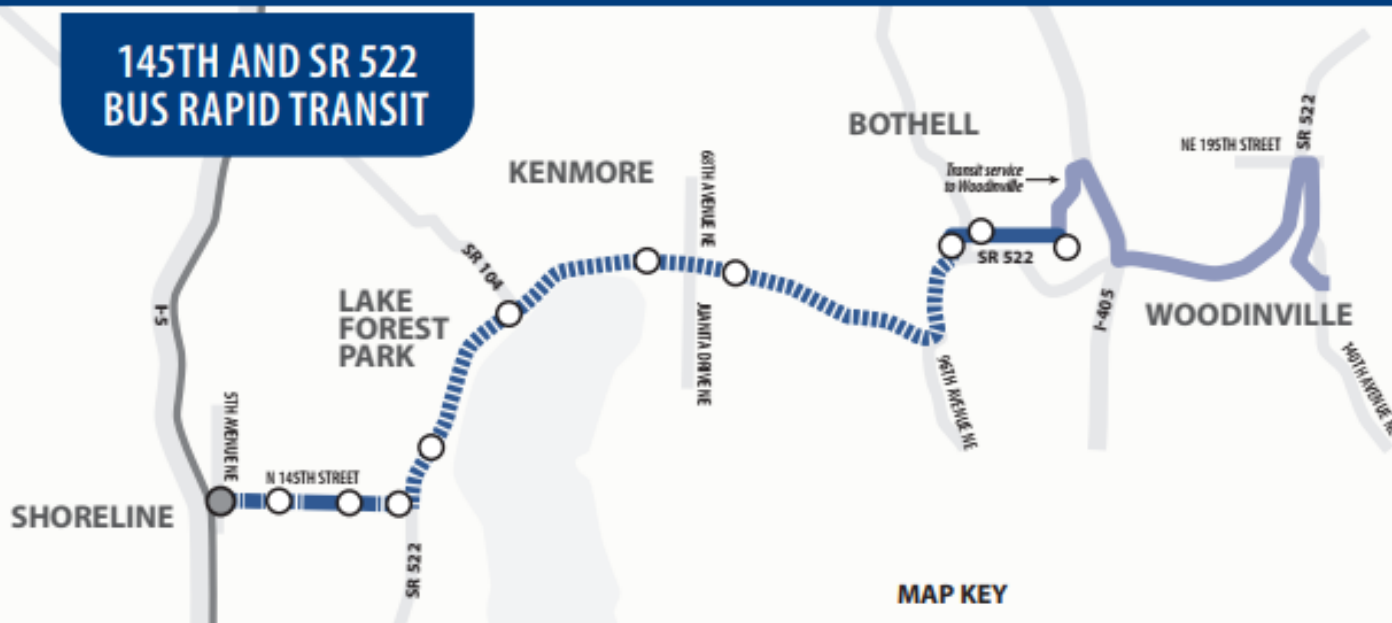

### 145TH STREET DETAILS

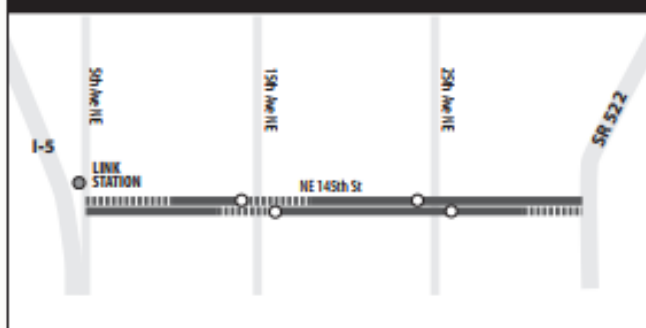

### MAP KEY

- BRT IN MIXED TRAFFIC
- BRT IN BAT LANES
- BRT STATION
- EXISTING FACILITY
- LIGHT RAIL SOUND MOVE/ST2

Alignments and stations shown are representative and are identified for purposes of cost estimating, ridership forecasting and other evaluation measures.



# What We Want to Hear From You

## Cross-section Concepts

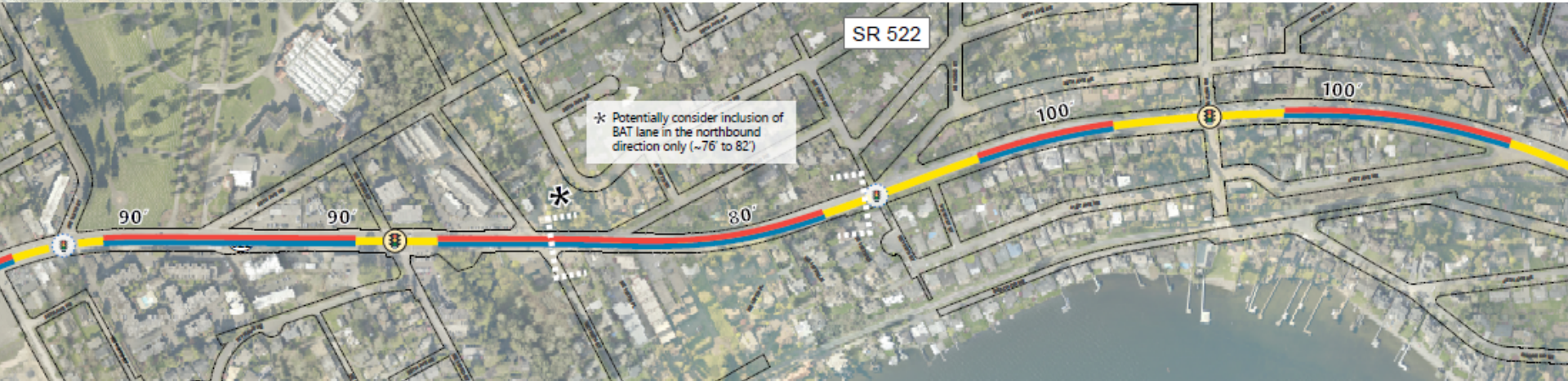
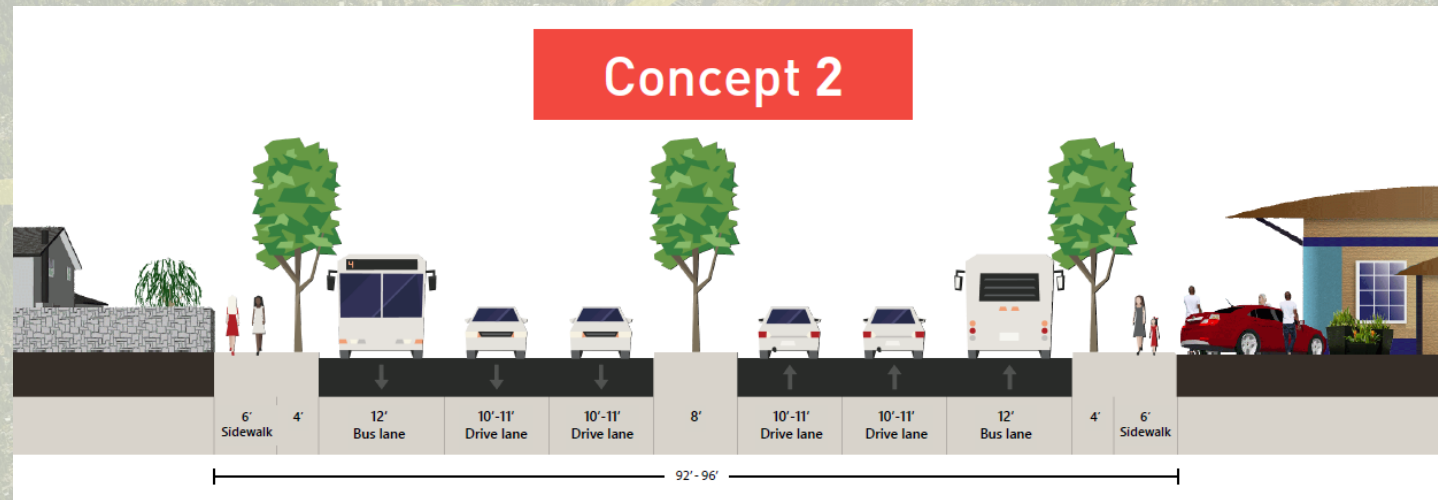



# What We Want to Hear From You

## 145<sup>th</sup> Intersection Improvements





# Non-Motorized Access To Transit



# Website & Public Face

[www.lfpsafehighways.com](http://www.lfpsafehighways.com)

Provides opportunities to  
provide input

& project materials:

- Project Guiding Principles
- Stakeholder Outreach Findings Memo
- Planning Context Report



[HOME](#)

[PROJECT FILES](#)

[GET INVOLVED](#)

[CONTACT](#)



Making SR 104 and SR 522 Work for Lake Forest Park



## The Safe Highways Project

The City of Lake Forest Park is looking at the two s  
522) and Ballinger Way NE (SR 104)—and exploring  
transit, and more walkable and bikeable.

Through this process, we hope to accomplish three

1. Examine scenarios that improve access a  
types of travel, including pedestrian, bicy





# Project Schedule

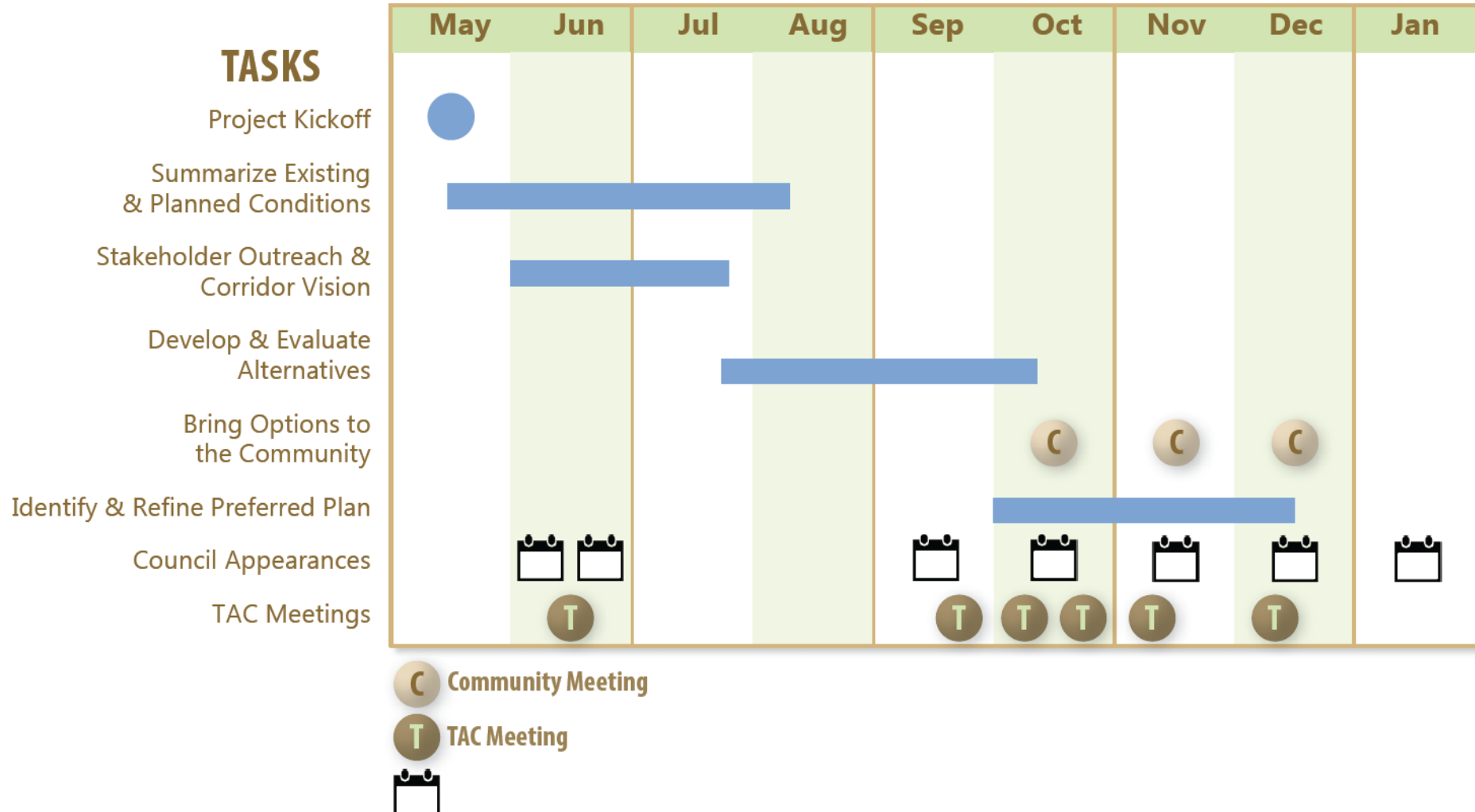

Save the Date: Monday, Dec. 4th

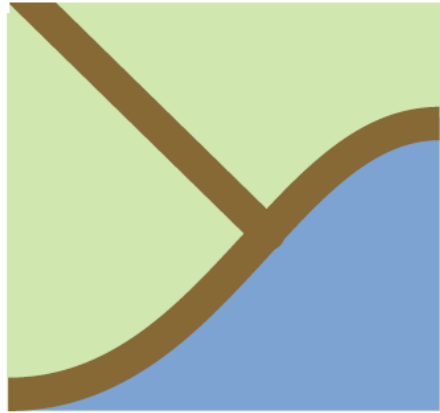

Lake Forest Park

**SAFE HIGHWAYS**

Accessible Efficient Complete

Join us for the third  
Open House!

SR 104 & SR 522

Monday, December 4

6:00 - 8:00 PM

Brookside Elementary

17447 37th Ave NE

[lfpsafehighways.com](http://lfpsafehighways.com)



# THANK YOU

---

Lake  
Forest Park



Lake  
Washington



For more information, please contact:

**Kendra Breiland, AICP**

Fehr & Peers

[k.Breiland@fehrandpeers.com](mailto:k.Breiland@fehrandpeers.com)

FEHR & PEERS



NE 145th St